

WestcombeNEWS



Free to 3800 homes, in libraries and shops and online

April 2025 No3

The Spirit of Spring, The Heart of the Community

What will the Silvertown Tunnel do for us?

Here are a few of the anticipated benefits set out by TfL: they are based primarily on computer modeling.



Journey times

The Scheme is forecast to reduce journey times through the Blackwall Tunnel by around 15 minutes northbound in the morning peak, and 14 minutes southbound in the evening peak. The attraction of shorter journey times can be expected to attract some drivers but the charges for using the Silvertown and Blackwall tunnels are expected to deter others, so that the overall vehicle demand is forecast to be managed by the tolls and only a 2% increase in traffic is anticipated in the first year. The tolls are also expected to deter some heavy goods vehicles (HGVs).

Impact on other river crossings

No significant impact is expected on traffic flows on Tower Bridge

(up 6% for HGVs but down overall), Rotherhithe Tunnel (up 4% overall), Woolwich Ferry (down 1%) or the Dartford Crossing (up 1%).

Impact on the A2 and A 206 (Trafalgar Road)

Queuing for the Blackwall Tunnel is expected to reduce, leading to slightly reduced journey time (3 minutes in the morning peak) from Falconwood to Sun in the Sands. Peak journey times eastbound in the evening between New Cross and Sun in the Sands are expected to increase slightly (2 minutes), and similarly westbound along the A206 towards Rotherhithe. The volume of traffic in Greenwich is expected to reduce.

Impact on air quality

The forecast is for a slight reduction in nitrogen dioxide (NO2) concentrations on the A102 southern approach road to the tunnel and no change in levels on the neighbouring crossings.

Many are sceptical about these forecasts and point to examples of the Dartford Crossing and M6 toll roads where traffic volumes rose in spite of the tolls. Both Greenwich and Newham Councils opposed the building of the Silvertown Tunnel which has cost £2.2 billion, funded through a Private Finance Initiative against future earnings. Concern has particularly focused on air pollution, including HGVs passing through Greenwich.

Traffic impact will be monitored extensively until at least 2028. We might then know if the predictions are correct.

Ann Hill

Enderby Wharf: A Historic Site on the Brink of Recognition

At Enderby Wharf the technology to allow international communication was developed from the 1850s and new cables were loaded onto ships until there until the late 1970s. Ever since then machinery has stood on the jetty – of great historic interest but with no status. It is not even ‘locally listed’!! We published an article about it in the March 2024 issue of the Westcombe News. <https://westcombesociety.org/westcombe-news-current-and-past-issues/>.

Last year local technology journalist, Alan Burkitt Gray, formally proposed to Historic England that it should list the jetty, telecoms cable gantry and winding gear as of architectural significance. Historic England has said, “it would be more appropriate to consider the site for scheduling rather than listing”. Alan says, “This is amazing – the

same level of protection that applies to our best historic monuments, such as Stonehenge and our Norman castles”.



Enderby wharf March 1981. Credit to RJM Carr

There is a vast amount of detail on the Atlantic Cable web site: <https://atlanticcable.com/CableCos/EnderbysWharf/index.htm>.

Updates on the Greenwich Industrial History Facebook Page.

Mary Mills

Further Closure of Blackheath Tunnel

The 1 mile tunnel takes trains between Charlton and Blackheath and was built 175 years ago.

It is prone to water damage which in turn leads to equipment damage and delays. From Sunday 18 May to Sunday 27 July 2025 inclusive, the tunnel will be closed to allow further maintenance work following a similar closure last year when soot was removed from the tunnel, bricks replaced and investigations into further work needed.

Services from Dartford to Cannon Street (via Charlton and Lewisham) will be moved to the Dartford line and add to the number of trains passing through Westcombe Park until this closure work is completed.

A series of 10 week closures is needed to bring fewer delays and improved reliability.

Over the course of the entire programme of works, thousands of bricks will be replaced and a new tunnel lining installed to stop water leakage.



Westcombe News April 2025

Mycenae House

Friday May 2
SONIC BLUE

Friday May 9
S.W.O.P

Friday May 16
ICARUS Acoustic Club

Friday May 23
CHRIS DIFFORD (SOLD OUT)

Friday May 30
Mississippi MacDonald

Tickets from WeGotTickets.com
www.mycenaehouse.co.uk
020 8858 1749
90 Mycenae Road, Blackheath, SE3 7SE

Mississippi MacDonald

WESTCOMBE SOCIETY

Westcombe News

PUBLISHER

The Westcombe Society
c/o 163 Westcombe Hill, SE3 7DP or
info@westcombesociety.org

CHAIR: Geoff Brighty

EDITOR: Christine Fells

EDITORIAL TEAM /
CONTRIBUTORS

Marilyn Little

Polly Morgan

Amanda Arthur

Helen Marley-Hutchinson

Anne Robbins

Ann Hill

Diane Blackwell

ALL EDITORIAL

CORRESPONDENCE/PRESS
MATERIAL TO BE SENT TO:

wnews@westcombesociety.org

Deadline for May copy

11th April 2025

SUB EDITOR

Annie Grey

ENVIRONMENT

Editor: Maggie Gravelle

All comments and queries to

Emily Norton: 0208 853 2756

environment@westcombesociety.org

ADVERTISING MANAGER

Marilyn Little

advertising@westcombesociety.org

Deadline for May Advertising:

14th April 2025

DISTRIBUTION/DELIVERY

Emily Norton and volunteers

Tel: 0208 853 2756

info@westcombesociety.org

PRINTING

Trojan Press.

Email: info@trojanpress.co.uk

www.trojanpress.com

The views expressed in the Westcombe News are not necessarily those of the Westcombe Society or of the Editor. We take all reasonable precautions to protect the interests of our readers by ensuring as far as possible the bona fides of our advertisers but cannot accept any responsibility for them. Any complaints should be addressed to the advertiser.

To access back numbers (in colour) go to:

<http://www.westcombesociety.org/westcombenews>

Westcombe Society Membership

We would be delighted to receive your support and annual membership subscription.

Family membership £15

Individual membership £12

Senior Citizens and Unwaged £6

Please send payment to:

Christine Legg, 69 Mycenae Road, London, SE3 7SE

or email:

membership@westcombesociety.org

Advertising Rates

SIZE	Per Issue Cost	5 Issue Discounted Cost
Standard 6cm x 6cm (one column wide)	£48	£220
2 x standard (horizontal or vertical)	£76	£350
3 x standard	£107	£485
4 x standard	£138	£620

Councillors respond to local concerns

Representatives of the Environment Committee of the Westcombe Society held a very useful meeting recently with Ward councillors to discuss some issues of local concern.

Top of the agenda was an update on **LTN implementation** and in particular on the monitoring and evaluation process. Traffic flow is being monitored by cameras at various locations. We are concerned about traffic displacement which might disadvantage those living in or near boundary routes. We requested a list of air pollution monitoring points and asked about other forms of monitoring e.g. bus journey times and incidents involving emergency vehicles.

We asked for clarity about the end date of the LTN consultation period. We stressed that it should be well after the Silvertown Tunnel opens and that monitoring of traffic and air pollution would need to continue for some time after the opening. We suggested that the consultation and monitoring should differentiate between the morning and evening closures so that results show more clearly how residents and drivers feel about, and are reacting to, the closures.

The matter of **Lime Bikes** was discussed. We understand some of the difficulties of dealing with the problem of poorly parked bikes and understand that the Mayor of London is being given some powers to fine operators who allow bad practices. Lime Bikes

recently published an action plan that includes pledges to improve bike parking, increase the on-street team, and conduct a campaign for safer riding (<https://www.lime/en-gb/londonactionplan>).

Greenwich is not one of the 16 partner boroughs, which we regret. Relocated **bus stops** on the heath are a concern for some residents as they are inconveniently placed, offer little protection in bad weather, and caused part of the heath to be paved over. No consultation regarding relocation had taken place with users or with the Blackheath Joint Working Party. We have asked councillors to find out when and why the decision was made to move the bus stops.

Following disappointment at the refusal of planning permission for the **Mycenae House lift**, the councillors and all concerned parties pledged to work together to encourage a re-application.

Wear and tear on the front garden outside the Waldorf School which occupies the grade II* listed building next to Mycenae House has been an issue for six years and the area remains an eyesore in a particularly sensitive location. Councillors agreed to talk to the new head teacher about effective enforcement of the landscaping.

Councillors agreed to follow up all the issues raised and suggested meeting on a regular basis to share concerns of Westcombe Park residents and to work towards their solution.

Maggie Gravelle

AGM

NOTICE OF MEETING

Members are invited to -
The Westcombe Society's - AGM 2025.

7.00pm on Friday 9th May 2025

LOCATION

In the Centenary Room at Blackheath High School by kind permission of the Head Ms Argile

AGENDA

- Welcome and apologies for absence
- Approval of and matter arising from Minutes of 2024 AGM
- Reports from the Chair, Events Sub-Committee, Environment Sub-Committee, Membership Secretary,
- Treasurer's Report and presentation of audited statement of accounts for year ending 31/03/2025

5. ELECTION OF OFFICERS

6. A.O.B.

Wine and nibbles will be served

Main Events this Spring and Summer on Greenwich side of Blackheath

3rd - 21st April: Easter Funfair

This runs virtually simultaneously with the Circus on the Lewisham side.

27th April: London Marathon

24th - 25th May: 4 Corners Festival

14th - 30th August: Summer Funfair

CARPENTER

Specialist in refurbishment, repair and replacement of sash windows, front doors overhauled.

Call

MALCOLM TIERNEY

07775 657371

Eggs-citing Easter Fun: The WS Egg Hunt Returns

Hands down the most popular Westcombe Society annual happening is the Easter Egg Hunt in Mycenae Gardens. And since this egg-citing event falls on April 19 this year, please get those creative juices flowing now to make amazing Easter bonnets and baskets. Topping last year's creations will need heaps of imaginative flair and we can't wait to see it on show.

There'll be lots more eggs snuggled in the undergrowth for sharp-eyed little ones to find and be rewarded with delicious treats.

For grown-ups, the Mycenae bar will be open all afternoon.

The fun is from 1.30 to 3.30 and let's hope the sun puts its Easter hat on!

Diane Blackwell

Blackheath Joint Working Party

Due to unforeseen circumstances the Annual Open Meeting of the above to be held in March was postponed. A new date will be published on www.westcombesociety.org as soon as possible. Come and hear what is happening on the heath and have your say.

Feedback on the LTN

Local Residents and Readers wishing to provide any feedback and comments to Greenwich Council, kindly now send these to the following email: Traffic.management@royalgreenwich.gov.uk.

WRISTWORTH HEATING & PLUMBING

Installation - Servicing - Repair

Tel: 07725 008280

Email: wristworth@hotmail.co.uk



Check Out Our **NEW** Website: wristworthheating.weebly.com

R.G. Austin

(Established 1963)



Heating Engineers,
Property Maintenance,
Electrics, Painting,
Decorating, Plumbing,
Central Heating,



Shower and Bathroom Specialists

2A Hassendean Rd, Blackheath SE3 8TS
Telephone: 0208 858 7359
rgaustintd@gmail.com

Emergencies: 07738124344
email: rgaustintd@gmail.com

NEIGHBOURHOOD

The Barons of West Greenwich

Among the 26 barons who signed Magna Carta was Geoffrey de Saye, Baron of West Greenwich, whose father had been granted the lands by Richard the Lionheart after the last member of the Maminot family, Wakelin Maminot, died without issue.

Maminot's sister, Alice, was married to Geoffrey de Saye, but he only managed to take ownership of the manor after a long dispute with another baron, Geoffrey de Mandeville, who owned the manor of Pleshey in Essex.

Geoffrey de Saye didn't linger long to enjoy his estate. In 1219 he went on a pilgrimage to the Holy Land. After his return he then went on another pilgrimage to Santiago de Compostela in the province of A Coruña, the capital of Galicia in northwestern Spain.

Then in 1230 he went campaigning with King Henry II in Poitou, and there he died on 24 August 1230.

His son, William, who inherited the manor of West Greenwich, died in 1271. The family died out, but they are remembered in the name Sayes Court, in Deptford, and Sayes Park, the site of the manor house where the diarist John Evelyn lived from 1653 – 1694. The manor was seized by Parliament in the Civil War, and given to Sir Richard Browne, who was a Major General in the Parliamentary army.

His daughter and heir, Mary, married the famous diarist John

Evelyn in 1647, but on the accession of Charles II in 1660, the manor reverted to the Crown. Evelyn took out a 99-year lease on the house in 1663. Future renters included Captain Benbow of the Royal Navy, and Tsar Peter of Russia, both of whom wrecked the building.

Only a small part of the original park now remains, but since 2017, a number of new trees have been planted, including two white mulberry trees and a Turkish walnut.

And the baronage? Charles II planned to make his mistress, Nell Gwynne, 'Countess of Greenwich,' but this plan came to nothing when he died in 1685. In 1705, Field Marshal The 2nd Duke of Argyll (1680-1743) was created Earl of Greenwich and Baron Chatham; he became Duke of Greenwich in 1719, but his titles became extinct on his death in 1743. His daughter, Caroline Townsend, was made 1st Baroness Greenwich, but this title became extinct upon her death in 1794.

The last Baron Greenwich was Lieutenant Philip Mountbatten on the day of his marriage to Princess Elizabeth, who became our Queen, when he also became Duke of Edinburgh and Earl of Merioneth.

When he died in 2021, the title passed to his son, Charles. It was merged with the crown when Charles became Charles III in 2022. Who will be the next baron? Applications in duplicate, please!

Neville Grant

Wigs, Weddings, Powder and Palaces

When walking around the Old Royal Naval College and its surrounds, have you ever spotted a location that has been used in film or TV; where Colin and Penelope got married in Bridgerton perhaps?



The Crown, Les Miserables and Pirates of the Caribbean are also amongst the 200 TV and film productions that have used the Old Royal Naval College to set the scene.



Seen as the UK's No.1 heritage film location and to celebrate 100 years of filming at this historic site, a new walking tour begins in April that will show you famous filming locations across this historic site. It will include entry to the Painted Hall and The Chapel of St Peter and St Paul, both providing settings for very well-known productions. Launching in April | Fri & Sat, 1.30pm & 3.30pm Tickets: £25, concessions: £19 For further details: ornc.org/whats-on

Local Young Dancers Tap Their Way to the World Stage

Three talented young dancers from the Blackheath School of Dance are set to represent Great Britain at the Dance World Cup 2025 in Burgos, Spain.



Colette (9), Titus (8), and Edie (9), who all live locally, have reached the prestigious final and will perform a tap dance trio to "Good Morning" from the classic musical Singing in the Rain. Competing as part of Team England, their achievement is a testament to their dedication and skill.

To help fund their journey, they are seeking sponsorship and community support. If you'd like to contribute, visit GoFundMe and search for "The Good Mornin' Trio" or go to <https://gofund.me/317df5d0> Let's cheer them on as they bring their talent to the world stage!

Letter

The Millennium Tapestry at St Luke's Church.

2000 years, mostly relating to Britain (including Greenwich and



Many WN readers may not know that half a mile along Charlton Road is St Luke's Church (rebuilt 1630), in which hangs a Millennium Tapestry. Very different in size, shape and content but also with a Bayeux Tapestry connection, it was made by stitchers from the parish, with local expert advice, between 1998 and 2000. It portrays secular and religious historical events over

Charlton). When the church is open to the public (several times a year) we have many interested visitors and would welcome more. For the more agile it is also often possible to climb 112 steps up the church tower for a (usually) good view. Please see our website charlton.church for details of open days.

Alison Leggat

BLACKHEATH PREP

Open Day

Visit us in person **Saturday 17 May 2025**

Applications open
Nursery (3+) - January & September 2026 entry
Prep (7+) & Occasional vacancies - 2025/26

Find out more blackheathprep.co.uk/admissions

Part of the Eltham College Family of Schools

FEATURES

The London and Greenwich Railway (L&GR)

The railway route between Greenwich and London Bridge was the very first suburban passenger railway route in the UK and one of the first in the world. Railways had been in existence for some time as the Victorian Industrial Revolution required fast transportation of coal and other freight. Previously goods were transported using the canal network.

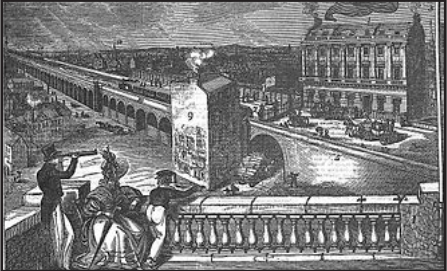

A former Royal Engineer, Colonel George Thomas Landmann, promoted the design and construction of the London and Greenwich Railway. A new replacement London Bridge had just been completed which gave better access from south east London to the north bank of the Thames and the City. The route between London Bridge and Greenwich was intended to give a better connection to the Naval dockyards and to the very popular attraction of Greenwich Park. An act of Parliament was passed in 1839 for the route between Tooley Street and Greenwich London Row. Landmann experienced many engineering problems as the route needed to cross existing roads, often at angles, the Grand Surrey canal and the river Ravensbourne at Deptford Creek before it could reach Greenwich. The unstable subsoil in the area, which was still undeveloped, was largely used for market gardens and meadows. The only practical solution was to elevate the railway on an almost four-mile

long viaduct which dispensed with the need for level crossings. Landmann pioneered the use of concrete for the 24ft deep foundations required for the arches but even then, iron ties were often utilized to prevent further movement in the structure when it occurred.

The viaduct required building 878 brick arches and 27 skew arches and iron road bridges. This necessitated using over 60 million bricks which caused a severe brick and building material shortage. The bricks were produced at works in Sittingbourne and transported upriver by barge to the site. The construction required a taskforce of over 400 navvies, mainly English and Irish men who needed to be housed in separate accommodation at some distance from each other as fights between them were frequent.

The River Ravensbourne at Deptford was crossed using a bascule bridge (drawbridge) to allow masted ships to pass. Deptford Creek bridge had problems from the start needing to be operated by eight men and was replaced in 1884 and again in 1963. It still exists but is now unused. The railway opened between Spa Road, Bermondsey and Deptford in 1836 following extensive locomotive trials and experiments with track laying. Spa Road thereby became London's very first railway station. A wooden staircase at the side of the viaduct gave passengers access to the station platform. Years later this station was moved a little distance and a booking hall with access to the extended platforms incorporated within the arches. It closed in 1915.

The line finally reached Greenwich in 1838. The present extremely fine station building dates from 1840. It

was the terminus of the L&GR until 1878 when a cut and cover tunnel was constructed in front of the Queen's House to link the North Kent line at Maze Hill to London Bridge.

The steam engines initially used were based on Robert Stephenson's Planet locomotives. At Deptford there still exists a carriage ramp enabling rolling stock carriages to be moved up and down to the high-level track or be stored under the viaduct's arches.



In 1839 the London and Croydon railway and the Brighton and London Railway joined the London and Greenwich viaduct and shared their line to London Bridge. In 1850 the London South Eastern joined and this necessitated that the junction at Cobbetts Lane be controlled by a pointsman. He was placed in a wooden tower for better visibility. Called the Cobbetts Lane Lighthouse it was to be the forerunner of the signal box.

When first built the viaduct incorporated a pedestrian boulevard for visitors who paid a penny toll to walk the route. This was short-lived since the viaduct had to be widened to the north and south numerous times to accommodate additional lines. Today many of the viaduct arches are used for workshops, storage, micro breweries, nightclubs and restaurants. Historic England has designated the viaduct as a Grade II structure. It is in fact the longest run of arches in the UK.

David Fletcher

Local Students Take on 60km Challenge for Breast Cancer Support Charity



Five students from Blackheath High School are embarking on a remarkable fundraising effort as part of their Silver Duke of Edinburgh's Award expedition. Over three days, the girls will trek approximately 60km through the New Forest while raising money for Future Dreams, a charity supporting those affected by breast cancer. Their goal is to raise £2000 for the cause. To support their efforts, donations can be made here:

<https://gofund.me/80758bb3>

TROJAN PRESS

PRINTING IN BLACKHEATH FOR YOU SINCE 1978

PRINTING SERVICES
DEADLINES HIT
QUALITY PRINTING

1a Lizban St

Blackheath, London SE3 8SS

Tel: 020 8853 2268

Email: info@trojanpress.co.uk

www.trojanpress.com

INVESTMENTS

PENSIONS

ESTATE PLANNING

STARKEY

FINANCIAL PLANNING

Contact us: 020 8853 7160
admin@starkeyfp.co.uk

2 Charlton Road, Blackheath Standard, London SE3 7EX

Independent and friendly advice from south east London's top team of Chartered Financial Planners

Starkey Financial Planning Ltd is authorised and regulated by the Financial Conduct Authority



The Pointer School

Part of **Dukes Education** Family

A leading London prep school for girls & boys 3-11 in Blackheath, SE London. Founded in 1950

“...our wonderful teachers and Head Teacher, Mrs Crookes. With patience, good humour, and just a little craziness, they have coaxed and inspired us to achieve things we would not have thought possible!”

Head: Charlotte Crookes

0208 293 1331 pointers.school [@pointerschool](https://www.instagram.com/pointerschool)

FEATURES

Marathon

The 45th annual edition of the London Marathon takes place on Sunday 27 April 2025 and will require road closures and parking restrictions in your area.

Tens of thousands of participants will take on the 26.2-mile course, which starts in Blackheath and Greenwich Park and passes through central London and Canary Wharf before finishing on The Mall in Westminster.

Blackwall Lane until 08:40 and after 13:35.

Please note: between the times stated, the Vehicle Crossing Point will not operate as TCS London Marathon participants will be using the full width of the roads. A full list of Vehicle Crossing Points across the whole route is available at londonmarathonevents.co.uk/london-marathon/road-closures



Road closure times

A short section of Shooters Hill Road and Charlton Way will close at 04:00 on Sunday 27 April while we install the Start Area gantry.

In order to make the event route safe, the following roads will close at 07:00: Shooters Hill Road, St Johns Park, Old Dover Road, Charlton Way, Vanbrugh Park, Charlton Road, Charlton Park Lane and Woolwich Road (A206).

Westcombe Park Road reopening times.

Roads will be reopened as soon as it is safe to do so. Roads to the south of Westcombe Park are anticipated to reopen by 14:30, while roads to the north of Westcombe Park are anticipated to reopen by 15:00.

Vehicle Crossing Point

Drivers will be able to cross the route from Vanbrugh Hill to

Parking restrictions

Any vehicles parked on the route will be removed from 04:00 on Sunday 27 April.

Please assist us by moving your vehicle off the route on the evening of Saturday 26 April. If your vehicle is relocated by event contractors, please visit trace.london to find it.

A & A LANDSCAPES Landscape Specialists

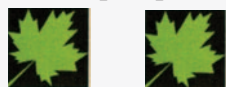

Free advice & estimates
Qualified horticulturalist

All aspects of soft & hard landscaping work carried out including
* Maintenance * Site clearance
* Turfing * Tree surgery
* Fencing * Patios
* Brickwork

Tel. 020 8318 2530

Is the Magna Carta out of Date?

As the world becomes increasingly threatened by dictators – or would-be dictators – who have no regard for national or international law, it's good to remind ourselves of Magna Carta – 800 years old.

On 15 June 2015, King John of England sealed Magna Carta at Runnymede. This document proclaimed the fundamental principle that everyone is subject to the rule of law . . . even a King. (Even a President . . .)

Until 1970, four clauses of the Magna Carta were still enshrined in English law. These were then reduced to three and a half. Two of the clauses are:

39 No free man shall be seized, imprisoned, dispossessed, outlawed, exiled or ruined in any way, nor in any way proceeded against, except by the lawful

judgement of his peers and the law of the land.

40 To no one will we sell, to no one will we deny or delay right or justice

In 1215, the Magna Carta was named The Articles of the Barons and was, in reality, really designed to protect the barons from the King. One of the 25 barons who signed it was Geoffrey de Saye, Baron of West Greenwich. It lasted just two months. The document was revised in 1217, with many of the clauses dropped; the Magna Carta only reached its final form in 1225. So we should only be celebrating its 800th anniversary this year – not as we did in 2015.

The founding fathers took the charter to America, and it was written into the Constitution of the United States in 1787 and was cited by the rebelling colonies in America. How long the spirit of the Magna Carta remains part of the US Constitution may depend on Mr Trump.

Acknowledgements: History Today, and Sean McGlynn, author of Blood Cries Afar: The Magna Carta War and the Invasion of England, 1215-1217 (2015), and Lecturer in History at the University of Plymouth at Strode College.

Neville Grant

ENVIRONMENT

Westcombe Woodlands News

We have been busy at the Woodlands. Having cleared quite a few trees, either because they were diseased or were invasive non-native species, we have made good use of the newly-cleared

the afternoon of Sunday 4 May we have our Bluebell Open Day when all are invited. There will be tea and cakes, crafts and pond-dipping for the children and, we hope, your company.



space. We had a major planting day on 2 March. Some 25 volunteers turned up to dig holes, fix stakes, and to plant and label over 50 new trees. They are all native species, some quite substantial, but also lots of smaller saplings that will grow into their spaces over a longer period. They include some that could become forest giants, such as oak and beech, others which our bees will especially love, such as limes and many smaller trees like hawthorn, spindle and blackthorn, which will provide food for pollinators and birds alike.

Meanwhile, the pond is full to overflowing, primroses are in flower and the bluebells are growing, but not yet showing any colour. Your next opportunities to join us are on Saturday 5 April and Sunday 4 May, when we will be open from 10am to 1pm for our regular Volunteer sessions. Come and give us a hand (or simply have a look round and a chat). Then on

A variety of whips soaking before being planted
Photographs © Pip O'Byrne

To sign up, visit our website www.westcombewoodlands.uk, and you will get notifications of events and our regular Newsletter. I hope to see you there soon.

Nigel Duncan, Chair, Friends of Westcombe Woodlands



A silver birch finding a new home
Photographs © Pip O'Byrne

Letter



A walk down Westcombe Hill

Possibly in response to our Newsbrief in the February edition, one of our readers, a local resident for 11 years, has written about her disappointment at the changes she had observed. What used to be a 'green and clean' area has become one with 'foul' and filthy streets.

The evidence is there in the photographs, although not everyone will have the same experience. The Council is currently consulting on Sustainable Streets. Unfortunately the deadline was 23rd March, but it is nevertheless worth contacting the Council and our Councillors about this issue.



Nesting birds - a reminder

As Spring arrives nesting birds need to be protected. The RSPB warn that birds are at their most vulnerable when nesting and that efforts should be made to avoid disturbing them. Any disturbance can cause adult birds to abandon their nests, eggs or young and activity which will affect them, such as felling, pruning and hedge cutting, should be avoided. The main nesting season is from the beginning of March to the end of July.



Domestic cats kill millions of our songbirds each year. Fledglings are particularly vulnerable. Birds are most active at dusk and dawn so keeping your cat indoors at night helps birds to remain safe. Research by the UK conservation organisation Songbird Survival found that 'BirdsbeSafe' cat collars reduce bird predation by 42%.

Intruder Alarms and CCTV

Affordable security services for your home and commercial property by a local security engineer with 30 years' experience.

CALL OR EMAIL FOR A FREE NO-OBLIGATION QUOTE



info@fanarsecurity.com || 07879011792

DBS CHECKED

PLANNING APPLICATIONS*

www.westcombesociety.org

72 FOYLE ROAD
Ref 25/0647/HD
To demolish and replace single storey rear extension, rear terrace and steps and replace pebbledash render and rear doors.
64 WESTCOMBE HILL
Ref 25/0716/CP
To convert loft and install dormer.
89 COLERAINE ROAD
Ref 25/0537/HD

* Please be advised that the planning applications noted here are based on information available at the time of print.

Spring into action in Mycenae Gardens

The volunteer day on 23rd of March was a busy one. With two handsome grants for plants, and with planting season suddenly upon us, we've been accumulating lots of material to go into the fenced off areas.

The aim is to provide lots of colour, shape, and foliage in the beds. With that in mind, we've been buying ferns and sarcococca (Christmas Box) for areas of deep shade, shrubs like mahonia for areas with more light, and all sorts of perennials for the sunny spots. We've also bought wildflower seed for the newly turned soil near

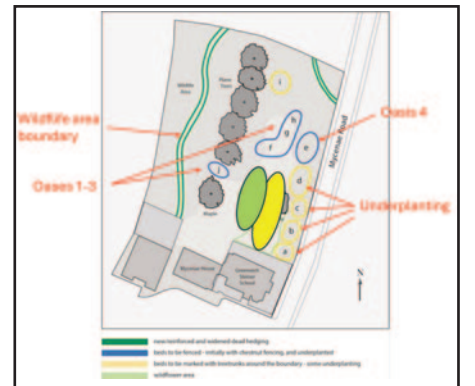

Caption: this map shows the key planting areas for Mycenae Gardens, with the wildflower areas in bright yellow and green and the newly planted beds circled in blue.

Woodlands. You'll see the results over the course of the summer! And it will be all hands on deck to water the new plants, so please take note of actions days. On Saturday April 12th, we have a special group joining us: the Scouts will be helping build up the dead hedging that protects the nature areas. We're so grateful to all our volunteers, including the Good Gym which brings running and manual work together. Their members were instrumental in clearing a number of overgrown shrubs recently, and raising the canopy of some of the holm oaks on the eastern boundary, bringing more light into the wildflower area.

This doesn't mean we will have completely finished the improvements. There are several areas still to tackle, on the northern edges of the Garden. The illustration gives some idea of where the newly planted areas are, and we hope they'll please the Gardens' users for years to come.

To extend and infill the double ridged roof and install two dormers to rear, and relocate one rooflight to front

TREE WORKS
4 ST JOHNS PARK
Ref 25/0828/TC

To fell 2 holly trees and 1 buxus in front garden, and 1 holly in rear garden.

For the latest updates, please visit our website
www.westcombesociety.org

WHAT'S ON

Cutty Sark

Cutty Sark concert: Richard Thompson

Experience an unforgettable evening under the hull of Cutty Sark with Richard Thompson - co-founder of Fairport Convention, British Folk Rock trailblazer, and one of the greatest guitarists of all time according to Rolling Stone.

Dates: 30 April, 1 May 2025

Time: 19.30 - 21.45

Age: Suitable for ages 16 and over

Location: Cutty Sark

Admission: Adults £40 | Members £36

www.rmg.co.uk/whats-on/cutty-sark/cutty-sark-concert-richard-thompson

Royal Observatory

Morning Stars – Beginners Show

Morning Stars is a planetarium show designed for anyone who would benefit from a calmer and more relaxed environment viewing the night sky, particularly those with autism. This 'Beginners' show is suitable for young children or for anyone who has limited experience with astronomy. Free companion tickets are available for this show.

Date: 7 April 2025

Time: 10:15 – 11:00

Age: Open to all ages

Location: Royal Observatory

Greenwich, Peter Harrison

Planetarium

Admission: £10 Adult | £5 Child |

Free Companion Tickets

Out of this World: Mars

Do you have what it takes to be a Martian? Join in for a morning of science and discovery at London's only planetarium as they explore the mysteries of Mars.

Date: 8 April 2025

Time: 10:30 – 12:00

Age: Suitable for ages 7-11

Location: Royal Observatory

Greenwich, Peter Harrison

Planetarium

Admission: £5 Child

Holiday to Space: Mars

Join mascots Ted and Plant on an adventure to Mars in this family planetarium show exploring the whole solar system.

Date: 10 April 2025

Time: 10:30 – 12:00

Age: Suitable for under 7s

Location: Royal Observatory

Greenwich, Peter Harrison

Planetarium

Admission: £5 Child

Morning Stars – Advanced Show

Morning Stars is a planetarium show designed for anyone who would benefit from a calmer and more relaxed environment viewing the night sky, particularly those with autism. This 'Advanced' show is suitable for older children, adults or anyone who would benefit from a more in-depth look into the subject of astronomy. Free companion tickets are available for this show.

Date: 11 April 2025

Time: 10:15 – 11:00

Age: Suitable for ages 7 and over, no under 5s

Location: Royal Observatory

Greenwich, Peter Harrison

Planetarium

Admission: £10 Adult | £5 Child |

Free Companion Tickets

www.rmg.co.uk

National Maritime Museum and Queen's House

EXHIBITIONS AND DISPLAYS

Pirates – NEW EXHIBITION

A major exhibition tracing the changing depictions of pirates throughout the ages and revealing the brutal history often obscured by fiction. While sometimes portrayed as tricksters or scoundrels, pirates are primarily swashbuckling adventurers associated with lush islands, flamboyant dress and buried treasure. The Pirates exhibition will deconstruct these myths and illuminate the realities of pirate life, including those of the pirates Edward 'Blackbeard' Teach, William Kidd, Anne Bonny and Mary Read. The exhibition will cover piracy across the globe looking at the South China Sea, Indian Ocean and Barbary pirates who operated off the coast of North Africa.

Date: 29 March 2025 – 4 January 2026

Time: 10.00 – 17.00

Age: Recommended for ages 10 and above

Location: National Maritime Museum,

Greenwich

Admission: Adult £15 | Child £7.50 |

Student £11.25

www.rmg.co.uk/whats-on/national-maritime-museum/pirates

national-maritime-museum/pirates

Astronomy Photographer of the Year

The Astronomy Photographer of the Year competition is now in its sixteenth year. The winners of the 2024 competition's nine categories, two special prizes and the overall winner are displayed in this exhibition at the National Maritime Museum alongside a selection of exceptional short-listed images. The competition is run by the Royal Observatory Greenwich, supported by Liberty Specialty Markets and in association with BBC Sky at Night Magazine.

Date: Daily

Time: 10.00 – 17.00

Age: Suitable for all ages

Location: National Maritime Museum,

Photography Gallery

Admission: Free

www.rmg.co.uk/astrophoto

The Keeper of All the Secrets

Jacqueline Bishop's The Keeper of All the Secrets is a major new acquisition that will go on display in the Queen's House. The Jamaican-born artist has adorned a traditional British tea service with collages of Caribbean market women intertwined with local flowers and plants. The work focuses on women's agency and resistance in the Caribbean, while exploring the legacies of the tea and sugar trades, empire and enslavement. It was developed in partnership with Culture&, as part of their programme Time, Space and Empire (2024-2025).

Date: From 21 March 2025 onwards

Time: 10.00 – 17.00

Age: Suitable for all ages

Location: Queen's House, Greenwich

Admission: Free

www.rmg.co.uk/queens-house

Blackheath Halls

Various children's shows in April

For details www.Blackheathhalls.com

Mycenae House

7th-8th & 14th-15th April 10am-4pm - Engineering Minds Holiday Club. Exploration, creativity & innovation for children 6+. £57 per day.

8th-9th April 9am-3pm - JK Performing Arts Holiday Club. A 2-day Wicked themed theatre workshop for children 4+. £40 per day.

Fri 11th April 7.30pm - The SWOP Sessions. Foot tapping, finger snapping, jazz, soul & blues with Open Mic. £8.

Wed 16th April 10am-3pm - Young Writers Workshop. Learn how to write fantastical myths and legends for ages 9-11, perfect for 11+. £135.

Fri 25th April 7.30pm - Mustard Seed. 4 piece band playing indie, funk & soul with electrifying extended jams. £10.

Fri 2nd May 7.30pm - Sonic Blue. Funky, rocking blues and R&B, expect an evening of danceable grooves. £10.

For further information about all Mycenae House events visit www.mycenaehouse.co.uk

Greenwich Theatre

Franz Kafka's The Hunger Artist (1st to 5th April)

Various shows for children including Where's Mrs Ladybird, The Detective Dog and The Very Hungry Caterpillar

<https://greenwichtheatre.org.uk/>

Greenwich Industrial History Society Speaker Programme

8th April: Julia Elton - Severndroog Castle and lighthouses.

Julia's recent research on lighthouses has revealed a previously unknown link.

13th May: Mary Mills - George Livesey. South London's revolutionary gas manager.

His biography is the subject of her latest book

10th June: Mark Stevenson - Recent work in local sites of interest.

Mark is Archaeology Advisor Historic England South London.

8th July: Ian Craig - 'The Watkins family and Ship Towing on the Thames.'

This will include information on preserved steam tug, Cervia.

9th September: Richard Allen - The North Kent Line.

Among other things Richard has been studying work on the tunnel between Blackheath Station and Charlton.

9th December: Alan Burkitt Gray - Scheduling the Enderby winding gear. With, hopefully, news of success and further work.

All talks will be by zoom at 7.30pm.

Thirty bookings can be made on the Greenwich Industrial History Facebook page and information on how to get the link will be posted there in the week before the talk.

also.

SATURDAY 12th APRIL at 11.00

JOHN KENNETT of Eltham will be conducting one of his notable walks on the Progress Estate. Meeting outside the Co-op at Well Hall at 11.00. if you plan to attend email Greenwichindustrial@gmail.com

Woodlands Farm



WOODLANDS FARM TRUST LAMBING DAY

SUNDAY 13th APRIL 2025

11am – 4pm

331 SHOOTERS HILL, WELLING, DA16 3RP

· SEE NEW BORN LAMBS · FOOD STALLS & CIDER
· CHILDREN'S ACTIVITIES · LOCAL PRODUCE
· TRACTOR / TRAILER RIDES (WEATHER PERMITTING) · CRAFT STALLS

ENTRY:
ADULT £2
CHILD (UNDER 16) £1
FAMILY £5
(2 adults and up to 3 children)

NO PARKING, PLEASE USE PUBLIC TRANSPORT. BUS 89 AND 486 STOP OUTSIDE APOLOGIES, NO DOGS ALLOWED (ASSISTANCE DOGS ONLY)

The Woodlands Farm Trust

Charity Registration No: 1051680

For further details visit our website: www.thewoodlandsfarmtrust.org

www.thewoodlandsfarmtrust.org



Easter Holiday Activities

Wednesday 16th April

Guided Farm Tours

Tours every half hour 10.30am - 2.30pm

£5 per child. Drop in event

A guided tour of the farm to see our animals and new born lambs.

Thursday 17th April

Where the Wild Things are

10am-12pm and 1pm-3pm

£7 per child. Booking essential

Explore the story with an adventure in the woods and crafts

Friday 18th April (Good Friday)

Egg-celent Easter Trail

10am - 2pm

£3 per child. Drop in event.

Join our annual Easter Egg trail around the farm.

More information and to book visit www.thewoodlandsfarmtrust.org

For more information, please contact us: education@thewoodlandsfarmtrust.org or 020 8319 8900

Parking is limited, so please use public transport where possible.

The Woodlands Farm Trust, 331 Shooters Hill, Welling, DA16 3RP

St Paul's Sinfonia

– talented local orchestra

Friday 25th April 2025

Symphonic Frontiers: Haydn,

Wallace and Sibelius

St Alfege Church, 730pm

<https://www.stpaulssinfonia.com/>

WOOLWICH WORKS

UNVEILS AN EXCITING SPRING SEASON OF FUN, COMEDY AND MUSIC Liat Rosenthal, Head of Creative Programmes, and the Woolwich Works team are delighted to unveil a packed programme of unmissable events this April, with something for everyone – from the music lover to comedy connoisseur.

Jay Rayner is one of Britain's most recognisable foodies as Masterchef judge and The Guardian's resident restaurant critic. However, not everyone knows that he is also an accomplished jazz pianist and has his very own sextet. Jazz Up the 80s with the Jay Rayner Sextet (3 April) see the group interpreting some of the decade's biggest hits from Sade to Sting to Swing Out Sister. Big hair and box-shouldered jacket are optional. Live At The Works comedy night returns on 26 April and will be headlined by none other than Troy Hawke. The self-styled president of the Greeter's Guild, whose online videos complimenting everyone from complete strangers outside Poundland, to joining Manchester City at training, have amassed millions of views over the last year. He's been a stand-up star for years and will be bringing his very own brand of comedy to SouthEast London! He'll be headlining a stellar line-up; Laura Smyth (BBC's Live At The Apollo) and Edinburgh Comedy Award-nominees Ania Magliano and Josh Pugh.

Tickets and information for all shows is available here:

<https://www.woolwich.works/whats-on>

MARKET PLACE

TUITION

FOR PRIVATE PIANO, singing, or music theory lessons, please contact eleanorcozensmusic@gmail.com.
GERMAN TUITION, language and literature, in person, local German teacher. All levels and ages, DBS checked. Please contact Dr Katharina Rist at 07533 061757 or rist@ristconsulting.com
SPANISH TUITION, on line, latinoamerican Spanish teacher. All levels and ages, GCSE, A levels. Please contact: Miguel at 07910318513 or migansiergut52@gmail.com
MATHS & ENGLISH TUITION TO GCSE AND PREPARATION FOR 11+ AND INDEPENDENT SCHOOL SELECTION TESTS by qualified and experienced teacher. marystuition.com
 Mary Bauckham 07709 089 838 marybauckham@gmail.com
MATHS TUITION
 Qualified and experienced secondary teacher offers tuition to GCSE level.
 Call Miv Whitaker: 07745 816338; or email miv.whitaker@gmail.com

SERVICES & TRADE

DV SERVICES PLUMBING & HANDYMAN Blockages & drains, Radiator valves and radiators not working, Change and fix toilets, sinks, showers & taps in bathrooms, toilets and kitchens. We can fix it! Call Daniel on: 07904 880 448
SPRING INTO SUMMER with garden maintenance by professional woman gardener. 0208 858 8139
FULLY INSURED & QUALIFIED CARPENTER joiner & general building work/ specialist in traditionally hand-made timber double glazed sash windows & doors/retrofit double glazing & vacuum insulated glass/ listed and heritage building work undertaken. Tel: 020 3375 8597 Mob: 07930 453 310 Email: joseph@mcnamarabuildinganddevelopment.co.uk
AMANDA ARTHUR
 Local gardener, mowing, pruning, planting, clearing, general garden maintenance based SE3
 Call 07976 899760.
VANBRUGH DOG WALKING.
 Insured, DBS checked, business references. £15 per hour for one dog; other prices on request. Please email: vanbrughdogwalking@hotmail.com
UPHOLSTERER
 Specialising in traditional upholstery.
 www.suemayesupholstery.net or phone 07932 040 298
PEST CONTROL SERVICES
 Mice, Rats, Squirrels, Wasps, Foxes etc. Local Service 07850 839 655
A MAN AND A VAN
 Tel: 020 8858 3889
 Mobile: 07885 917842

T.TA ELECTRICS. NICEIC Approved Contractor, Quality Tradesman. All electrical work undertaken, Fully Insured & Guaranteed.
24HR EMERGENCY ELECTRICAL.
 Please call Tony on 07961 509 403 OR 020 8488 7425 OR info@ttaelectrics.co.uk
HOMEWORKS All-round handyman for those DIY's you have no time for! General repairs. Painting & Decorating. General Carpentry and flooring. Flat-pack assembly. Patio and deck cleaning. No job too small.
 Contact Matthew Barron 07903 388658
ELECTRICIAN / ALARM & CCTV ENGINEER
 30+ years' experience – No job too small
 Call: 07879 011792

WESTCOMBE CLEANERS
 I'm a friendly, hard-working & organised domestic cleaner. Regular or single services. Competitive rates. Additional tasks. I love my clients to be happy. Phone 07746 291617
TOM ELLIS
BESPOKE CARPENTRY
 Alcove bookcases, cabinets, wardrobes and window seats. M. 07510 869 947
MARK CHEESEMAN, LOCAL CARPENTER AND JOINER WITH OVER 30 YEARS EXPERIENCE.

All Aspects Of Carpentry and Construction Executed Considerately and to a High Standard. Both Traditional and Contemporary Design Joinery - Cupboards, Window seats, Floating Shelves, Engineered Flooring Fitted Etc. Also Locks Changed. Sash Window Overhaul. If you have Rotten Window Sills, Door Frames Etc. rather than replace them with the associated upheaval and expense, why not have a Timber/Resin Repair? Please Call Mark on 07767 456131 or H: 020 8854 4028.
ANGELO, ELECTRICIAN
 No Job Too Small
 T - 020 87616012/
 M - 07850 767 283
 Email - angelo@glennies.net
 Part P Certificated
 18th Edition & JIB Registered
LOCAL CARPET CLEANER
 Specialist in cleaning Carpets, Upholstery & Rugs.
 www.carpetcrew.co.uk
 Phone 07828503132
HOME MADE: Personalised SPECIAL OCCASION AND

CAKES

BIRTHDAY CAKES,
 Banana cake and muffins etc.
 Lunches: Hot meals, Pastries and Baguettes etc .
 Made with ♥ Love!
 Menus are available.
 Call : 07904 880 448

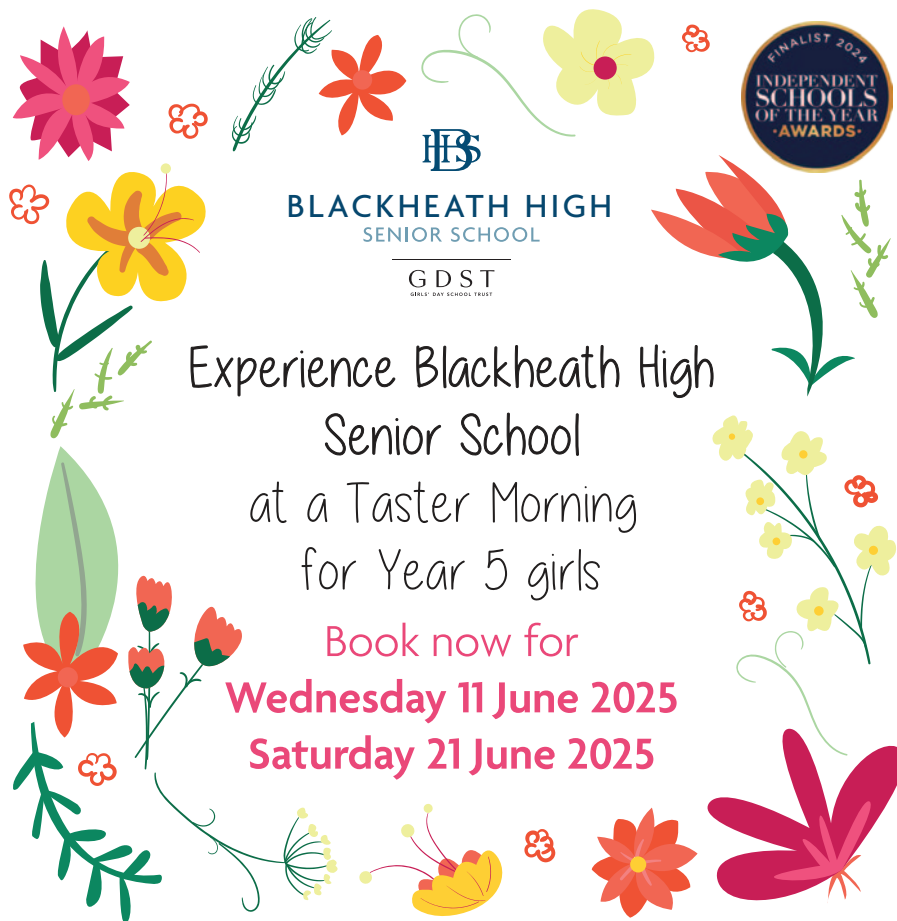

BLACKHEATH HIGH SENIOR SCHOOL
 GDST

Experience Blackheath High Senior School at a Taster Morning for Year 5 girls

Book now for
Wednesday 11 June 2025
Saturday 21 June 2025

DISCOUNT!

(When you show your Westcombe Society membership card)

ALL CITY LOCKSMITHS LTD
 offer upto a 15% discount for local residents
ROYAL NEPALESE RESTAURANT (Station Crescent)
 20% OFF meals for two or more Sunday - Thursday.
COTON & HAMBLIN LENS CLUB-
 Complimentary standard coated single vision lenses worth £50 when purchasing complete spectacles.
 T's & C's apply.
BLACKHEATH EYECARE OPTICIANS
 Money-saving Eyeplan membership offered
TROJAN PRESS 10% OFF all quotations
WESTCOMBE DRY CLEANERS
 10% discount on Dry Cleaning. Cannot be used in conjunction with any other offers.
A * DRIVING SCHOOL
 £5 discount on the price of one x 2 hour lesson

KAREN STOREY OF HOMESPACE offers members 10% discount on decluttering & homestaging: 07951 191086
SHENDA FALVEY PERSONAL TRAINING, STOTT PILATES & BOOTCAMPS
 M: 07887727335
 E: shenda@shendafalveypersonaltraining.co.uk
 Free Bootcamp worth £12.50
 Free PT/ Pilates Consultation with 20% off first session

PAINTING & DECORATING

Interior/Exterior/
 Experienced Reliable Clean
 Fully Guaranteed/Insured.
 References available.
 Free no obligation quote and advice given

JOHN at JAMES & LAMONT
 Office 020 8462 4646
 Mobile 07802 535695
 jamlam.john@btinternet.com



BICKLEY PARK SCHOOL
 INDEPENDENT PREP SCHOOL FOR BOYS & GIRLS AGED 2½-13

Join us for a
Saturday Stay & Play!
17th May
 9.30am - 12 noon

An Open Morning for Nursery & Reception

Register at bickleyparkschool.co.uk