

WestcombeNEWS



Free to 3800 homes, in libraries and shops and online

November 2024 No 9

“November's sky is chill and drear, November's leaf is red and sear.” - Sir Walter Scott

Noise Barrier Update from TfL

Transport for London (TfL) will begin construction of a new noise barrier along parts of the A102 in November, as part of its planned works for the Silvertown Tunnel.

The construction works, which involve piling the noise barrier posts into the ground and the installation of the noise barrier itself, will start in early November 2024 and are expected to be complete by early 2025. The work will be phased across different sections of barrier, with some elements requiring night-time working to enable the necessary protections to be put in place on the A102 to ensure the workforce always remain safe.

parts of Westcombe Hill, Siebert Road, and part of Invicta Road, following extensive studies from our acoustics experts to ensure a reasonable reduction in noise at this location. The height will then increase to around three metres at the southern end of Invicta Road to enable taller buildings and flats on higher levels in this area to also receive the benefit of the noise barrier.

Work on the Silvertown Tunnel continues to progress. Around the entrances to the tunnels, road realignment works are nearing completion and landscaping continues. Recently, TfL confirmed that Stagecoach have won the tender for the new



As part of the Silvertown Tunnel scheme, TfL committed to a number of enhancements for the local communities either side of the river, including the installation of noise barriers to address pre-existing noise along the western edge of the A102, between the junction with the B210 Charlton Road and the railway viaduct. A public consultation was carried out on the plans in late 2021, and the Royal Borough of Greenwich were also consulted on and approved the final plans.

The timber barrier, which was the preferred material chosen following local consultation, will be around two metres high along

‘Greenwich Portal entrance’ accredited to TfL cycle-shuttle bus, which will be served by electric buses. The route will operate at least a five bus an hour service between 06:30 and 21:30, seven days a week and will allow people with bikes to safely cross the river. TfL are now preparing the roads, vehicles and infrastructure for the new cross-river bus network and cycle shuttle-bus, as well as implementing the highway changes needed before the tunnel opens. More information about the Silvertown Tunnel project please visit :

www.tfl.gov.uk/silvertown-tunnel

TfL

East and West Greenwich LTN scheme trial

The ‘trial’ of the controversial Low Traffic Neighbourhood (LTN) in East and West Greenwich, including Westcombe Park, is due to start on 27 November 2024. The Royal Borough of Greenwich calls this the West and East Greenwich Neighbourhood Management Project and claims that it will reduce traffic levels and pollution. In effect it is an LTN and will affect all those who use vehicles other than bicycles in the Westcombe Park, East Greenwich or West Greenwich areas. It will also affect those who live or work on boundary roads or in the surrounding area.

for an exemption can be found at royalgreenwich.gov.uk/traffic-management-scheme. All residents should have received a letter and leaflet about the scheme. Further information can be found at royalgreenwich.gov.uk/greener-safer-greenwich. Scroll down this page and click on West and East Greenwich neighbourhood management trial – November 2024 (<https://greenersafergreenwich.com/place.is/en-GB/proposals/west-and-east-greenwich-neighbourhood-management-project-trial/step1>). Maps of all areas affected plus information on how to access your

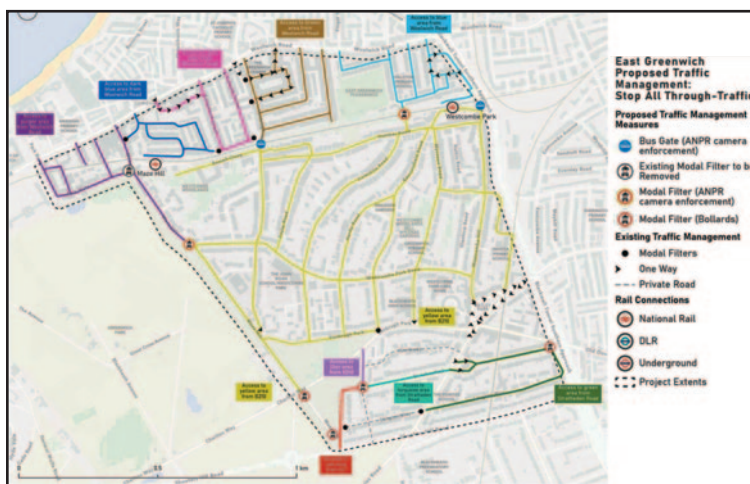

road are also downloadable from this page.

This is a trial of the LTN in that it will be in place for up to 18 months after which it will either be

All homes and businesses will continue to be accessible by vehicles at all times but, in Westcombe Park, vehicles crossing the railway on Maze Hill, Vanbrugh Hill, Halstow Road or Westcombe Hill and all vehicles entering St Johns Park, other than from Stratheden Road, will be fined between the hours of 7 to 10am and 3 to 7pm, Monday to Friday, unless their owners have applied for and received an exemption. Details on how to apply

made permanent, changed or removed.

Residents will be able to comment on the trial at royalgreenwich.gov.uk/greener-safer-greenwich for six months starting on November 27 2024.

Residents can also email/write to the following addresses:

Traffic.management@royalgreenwich.gov.uk

Mycenae Live
Mycenae House
Friday 1 November 7.30pm
Mexican Day of the Dead
Live Maruachi Band & Mexican Food
Friday 15 November 7.30pm
Dave Sutherland
Special Guests Siobhan Parr & Damien Renouf
Friday 22 November 7.30pm
Adrian Legg
“A guitarist of great power and invention”
Sunday 24 November 11-4pm
Corner @ 96 present **Christmas Fair**
www.mycenaehouse.co.uk 020 8858 1749
Tickets from
WeGotTickets.com/location/13865
90 Mycenae Road, Blackheath, SE3 7SE

WESTCOMBE SOCIETY

Westcombe News

PUBLISHER

The Westcombe Society
c/o 163 Westcombe Hill, SE3 7DP or
info@westcombesociety.org

CHAIR: Geoff Brighty

EDITOR: Christine Fells

EDITORIAL TEAM / CONTRIBUTORS

Marilyn Little
Polly Morgan
Amanda Arthur
Helen Marley-Hutchinson
Anne Robbins
Ann Hill
Diane Blackwell

ALL EDITORIAL
CORRESPONDENCE/PRESS
MATERIAL TO BE SENT TO:
wnews@westcombesociety.org
Deadline for Dec/Jan copy
15th November 2024

SUB EDITOR

Annie Grey

ENVIRONMENT

Editor: Maggie Gravelle
All comments and queries to
Emily Norton: 0208 853 2756

ADVERTISING MANAGER

Marilyn Little
advertising@westcombesociety.org
Deadline for Dec/Jan Advertising:
18th November 2024

DISTRIBUTION

Emily Norton and volunteers
Tel: 0208 853 2756

PRINTING

Trojan Press.
Email: dave@trojanpress.co.uk
www.trojanpress.com

The views expressed in the Westcombe News are not necessarily those of the Westcombe Society or of the Editor. We take all reasonable precautions to protect the interests of our readers by ensuring as far as possible the bona fides of our advertisers but cannot accept any responsibility for them. Any complaints should be addressed to the advertiser.

To access back numbers (in colour) go to:
<http://www.westcombesociety.org/westcombenews>

Westcombe Society Membership

We would be delighted to receive your support and annual membership subscription.

Family membership £15
Individual membership £12
Senior Citizens and Unwaged £6

Please send payment to:
Christine Legg, 69 Mycenae Road, London, SE3 7SE

or email:
membership@westcombesociety.org

Advertising Rates

SIZE	Per Issue Cost	5 Issue Discounted Cost
Standard 6cm x 6cm (one column wide)	£48	£220
2 x standard (horizontal or vertical)	£76	£350
3 x standard	£107	£485
4 x standard	£138	£620

Newsbriefs

Car Parks for Sale

At the Cabinet meeting of the Council held in mid-October, councillors decided to sell off three council car parks, including the one in Old Dover Road. The sites will soon go on the market in an effort to balance the budget. Other sales could include some public toilets and the Greenwich mortuary.

Fly-posting



Some residents of Blackheath are concerned at the amount of fly-posting in the village. Much of



this appears to be about events on the Heath. The Blackheath Joint Working Party wondered if this was an issue in Westcombe Park, particularly around the Standard. The response suggests that it is not a problem but organisers are urged to remove flyers, including the plastic ties, quickly after the event.

Deborah Ubee Trust: Centre for Emotional Health

20 Egerton Drive, SE10 8JS

The Deborah Ubee Trust counselling centre promotes emotional health and well-being, supporting adults, adolescents and children. The DUT is holding a 'showcase' event for community networks and organisations highlighting the work of the centre; how its counsellors work with different client groups.

The event will be held on Wednesday 13th November 10am – 12pm, includes refreshments and is open to members of the Westcombe Society

If you would like to attend, please reply to this posting including your full name, organisation and email address to:

<https://thedeborahubetrust.org.uk>
Sally McCarthy, Centre Manager, will then send you an invite.

Macmillan Magic



As ever, Westcombe Parkers rallied to raise all important funds for Macmillan Cancer Support. Rain couldn't dampen enthusiasm for The Westcombe Society's coffee morning in aid of this vital charity as the room buzzed and the cakes and sandwiches were heartily consumed. Mayor of Greenwich, Jit Ranabhat, arrived just as the sun came out and chatted to locals. Another very welcome guest was

Andrew Gould from Macmillan Cancer Support. A big thank you to Mycenae House staff for their tireless efforts to help make the coffee morning a huge success. Two days later saw more fundraising when the popular annual Macmillan Walk kicked off from Cutty Sark with participants glad of the clear skies as we headed along the Thames and the Regent's Canal to Victoria Park. Much fun was had by all and a delicious lunch at the park capped a splendid jaunt. The grand total raised from both events was £1,200.
Diane Blackwell



Advertising Manager

The Westcombe News seeks a new advertising manager. Tasks in this voluntary position include responding to queries for new ads, invoicing and monitoring payment. Many advertisers pre-pay for future ads, so monthly invoicing is minimal. Basic spreadsheet skills a bonus but training could be given. Around 7/10 hours over the month would be needed. Please contact Marilyn on Advertising@westcombesociety.org or 07939386215

CARPENTER

Specialist in refurbishment, repair and replacement of sash windows, front doors overhauled.

Call
MALCOLM TIERNEY
07775 657371

Anyone interested in singing Madrigals?

We would like to hear from anyone interested in joining a Madrigal Group in Blackheath/Westcombe Park to meet once a month. If interested, please email info@westcombesociety.org or phone 020 8853 2756.

Brain Drain for Charity

What better way to rev up a cold winter's evening than with a quiz that fires the brain and raises money for charity?

If you're not already in training for our quiz on November 30th, then it's now time to cram!

You'll be bringing your general knowledge to Mycenae House, 7.00 for 7.30pm, tables of 6 will compete for a prize, and if you need sustenance at half time, a fish and chips feast is £12 per person. For Westcombe Society members the evening's fun costs £7, for non-members it's £8.

BOOKING DETAILS: Tessa awaits your call or text - mobile number 07757 105 808 during the day; landline 020 3759 5117 after 7pm.
Diane Blackwell

Call for volunteers to help deliver the Westcombe News

The Westcombe Society is looking for volunteers to help with the delivery of our local paper. We currently have a few vacant rounds and often need cover. We're also seeking help with counting out the papers for distribution, a task that would take less than an hour of your time. Volunteers are needed up to ten times a year - any amount of time you can offer would be greatly appreciated! If you're interested in helping keep our community informed, please get in touch by emailing info@westcombesociety.org or calling 020 8853 2756.

R.G. Austin

(Established 1963)
Heating Engineers,
Property Maintenance,
Electrics, Painting,
Decorating, Plumbing,
Central Heating,
GAS SAFE

Shower and Bathroom Specialists

2A Hassendean Rd, Blackheath SE3 8TS
Telephone: 0208 858 7359
rgaustintd@gmail.com

Emergencies: 07738124344
email: rgaustintd@gmail.com

NEIGHBOURHOOD

The Poppy Appeal – 25th October to 11th November 2024



Captain David Kerr hopes our readers will find it helpful to know in advance that if the weather is dry he hopes to bring round poppies and enamel lapel badges when he makes his usual door to door collection in Westcombe Park between Thursday 31st October and Thursday 7th November. He will collect under cover at Marks & Spencer on wet days throughout the appeal and also on Friday 8th, Saturday 9th and Monday 11th November. David Kerr will have a card reader and can accept donations by card, cash or cheque. He asks that cheques or CAF vouchers be made payable to "The Poppy Appeal".

Greenwich to Woolwich walking and cycling changes

TfL consultation; walking and cycling Greenwich to Anchor and Hope Lane

(<https://haveyoursay.tfl.gov.uk/greenwich-woolwich>)

In July 2024, TfL published a report into the results of the consultation on changes to the cycle route between Greenwich and Woolwich. This report dealt with the nature of the consultation and of the respondents and gave a summary of the issues raised.

1,309 people participated. The majority of respondents came from north of the borough but there were also comments by people from further afield - Lewisham, Southwark, Thamesmead for example. The 36-40 age group represented the largest share of respondents and they were predominantly cyclists (32%). 8% of the group described themselves as disabled.

Since July TfL have continued to monitor the data relevant to the 'experiment'. At the end of September it published its response to the 'issues raised'.

Many criticisms concerned increases in traffic and congestion resulting in more noise and pollution. Some members of the

Borough Hall - an update

In May we reported that the Borough Hall had been acquired by a development company, Lita Homes, for nearly £2.5 million. The plan, which was submitted to the Planning Board was to turn the space into 80 flats. Subject to some amendments, such as increasing the number of flats with affordable rents, permission was granted in March this year. Now, according to Greenwich Wire, the company is in talks with the Council over plans to convert it to a hotel. The planning director for Lita Homes is quoted as saying that the company wanted to convert it to a hotel, "It's a beautiful building – we want to retain the building and do some additional work, and get some income for the borough as well as us." Meanwhile, it appears that the venue, which currently has two halls, is available for hire. It features on several hall hire websites some of which make a feature of the Art Deco interior. A number of local residents have expressed concerns about the noise that could result.

public argued that bus journeys were taking longer than previously and that increased congestion resulted in longer journey times. To these points the standard reply from TfL was: "Our data shows a number of spikes in journey time which we believe are mostly associated with works undertaken on the A206 and surrounding area. This shows the A206 corridor has limited resilience when significant works or disruption occurs."

Other public comments were more specific, for example, arguing that bus stops between the road and the cycle lane were unsafe, or that the layout at particular junctions was confusing. To these criticisms TfL replied: "Should the scheme be retained on a permanent basis, we intend to carry out some works to respond to the monitoring and feedback, and to support its longer term use." There are further comments about specific roads, some of which TfL will pass on to the Council as the relevant authority.

TfL point out that it is now up to Royal Borough of Greenwich to consider all the data and comments and to decide on future action.

The Vanbrugh Ensemble

Those who attended the concert on 12th October at St Margaret's Church, Lee, by the Vanbrugh Ensemble were in for a treat – in fact, three treats. First, a very atmospheric tone-poem by Anatoly Lyadov took us all, as if by magic, to The Enchanted Lake, lit up by the moon.

By way of contrast, Chopin's second piano concerto left the audience, and no doubt the brilliant soloist, Liana Storey, breathless – almost over the top. For the pianist in particular, a very demanding piece.

The highlight of the concert was Scheherazade by Rimsky-Korsakov, a superb piece of orchestration that remains fresh and enchanting however many times one hears it: a challenge to the Vanbrugh Ensemble which they rose to with a vengeance. Simon Standage, the solo violinist was, as always, astonishing.

The Vanbrugh Ensemble was formed in 2013, and based in Blackheath, by local musicians with

friends and colleagues from the music fraternity and has since offered opportunities for young conductors and talented young musicians at the threshold of exciting careers, a number of whom have since achieved international standing.

The ensemble is named after Sir John Vanbrugh, an eighteenth-century English architect and dramatist, best known as the designer of Blenheim Palace and as the successful author of Restoration comedies and celebrated bon mots - 'the want of a thing is perplexing enough, but the possession of it intolerable'. Sir John built his London residence, Vanbrugh Castle, on Maze Hill on the edge of Blackheath.

The Vanbrugh Ensemble is a non-profit organisation funded by private musicians and receives no public subsidy. The next concert will be mainly Mozart at St Michaels & All Angels, Pond Road, (Blackheath Cator Estate) SE3 9JL on Sat 1st Feb at 7.30 pm. *Neville Grant*

Never too Early for Christmas Shopping

We are fortunate to have an eclectic and attractive mix of shops and businesses in our area. Some old, some new and some refurbished and all worthy of our



custom. In this I include the printers Trojan Press who are an essential part of the production of every issue of this paper despite the worrying decline in printing companies. Without them there would be no Westcombe News.

With Christmas coming please support your local shops for your festive needs and our printers for your bespoke card printing and calendar needs. There are no minimums orders, please contact David on 020 8853 2268, email info@trojanpress.co.uk or pop into 1a Lizban St SE3 8SS anytime from 9-3 Monday - Friday



BICKLEY PARK SCHOOL

INDEPENDENT PREP SCHOOL FOR BOYS & GIRLS AGED 2½-13

Be All You Can Be

**Weekly Tours
Come
and Visit**

Find out more here:



**Welcoming
girls and boys
from Nursery
to Year 3 in
Sept 2025**

14 & 24 Page Heath Lane, Bickley, Bromley, Kent BR1 2DS

www.bickleyparkschool.co.uk

FEATURES

Cavalleria Rusticana at Blackheath Halls Opera

We were in for another operatic treat with Blackheath Halls Opera continuing opera. Based around three main scenes with the chorus, the famous Easter



Photographer Craig Fuller

their community season this autumn.

Returning home from military service, Turiddu discovered that his fiancée Lola, had married Alfio, a rich neighbour. In revenge, Turiddu began a relationship with another woman from their village, Santuzza, despite his mother's misgivings. However, while Alfio is away on business, Lola and Turiddu have started seeing each other again...

This opera is usually paired as a double bill with 'I Paglaicci', but these days with other single smaller operas. This staging was largely set around community opera and lends very well for this production to be done by Blackheath Halls

Hymn scene has them all on the stage at an angle backwards looking outwards. The chorus sang extremely well and were very well rehearsed.

Of the principles, Katherine Broderick (Santuzza) had an outstanding voice – full-bodied and crystal clear. Oliver Johnston's Turiddu gave much voice to his character. Michel de Souza's Alfio had a strong baritone quality. Janis Kelly gave her Lucia much authority. Idunnu Munch returned to Blackheath opera as Lola, although in a smaller role, she added the necessary allure to the storyline.

The orchestra and chorus had a great mix of amateur and professionals taking part as well as Trinity Laban students as section leaders in the chorus, which made this whole performance an exceptional community musical feast for the senses.

For more from Blackheath Halls, visit: www.blackheathhalls.com/whats-on/

Polly Morgan



Photographer Craig Fuller

Greenwich Housing Society's Annual Garden Party

Greenwich Housing Society held its annual garden party in the garden of Hatfield Court on September 14th. On what turned out to be a beautiful sunny afternoon, GHS residents were



treated to afternoon tea in the sunshine, with entertainment provided by Terence Green. Steve Kerridge, GHS committee chair, welcomed fellow committee members to the event, along with local councillor for Blackheath Westcombe ward, Christine St

Matthew-Daniel. GHS provides affordable homes for rent for people approaching pensionable age who have a connection with the Royal Borough of Greenwich and neighbouring boroughs south of the Thames and has been part of the local community since its formation in 1958. A timeline of the history of the Society was on display at the garden party, taking readers through its inaugural years (including a dinner at the Houses of Parliament) to its two current locations at Glenluce Road and Hatfield Court. All enjoyed this year's event and the opportunity to spend time with fellow residents and neighbours; for more information about Greenwich Housing Society, please visit their website:

www.greenwichhousingsociety.org.uk/

Dick Whittington and His Cat: Panto Magic at Greenwich Theatre



Join Dick Whittington and his Cat as they seek fame and fortune in an adventure through good old London Town! Can he outwit the evil King Rat, defeat his gang of revolting rodents? Will he win the beautiful Alice Fitzwarren's hand in marriage and become Lord Mayor of London? Find out in this pantomime paved with gold!

Following our Offie Award-winning panto in 2019 and our nominations for Robin Hood and Snow White, Dick Whittington and his

Cat will once again see the return of the much-loved Greenwich Theatre Pantomime production team.

Written by and starring Greenwich Pantomime veteran Anthony Spargo – back for his 11th year! Musical Direction by 'Uncle' Steve Markwick

Directed by James Haddrell
Age Recommendation: For All Ages | Running Time: 2 hours 30 minutes inc. interval | Content Warnings: TBC

INVESTMENTS

PENSIONS

ESTATE
PLANNING

STARKEY
FINANCIAL PLANNING

Contact us: 020 8853 7160
admin@starkeyfp.co.uk

2 Charlton Road, Blackheath Standard, London SE3 7EX

Independent and friendly advice from south east
London's top team of Chartered Financial Planners

Starkey Financial Planning Ltd is authorised and regulated by the Financial Conduct Authority

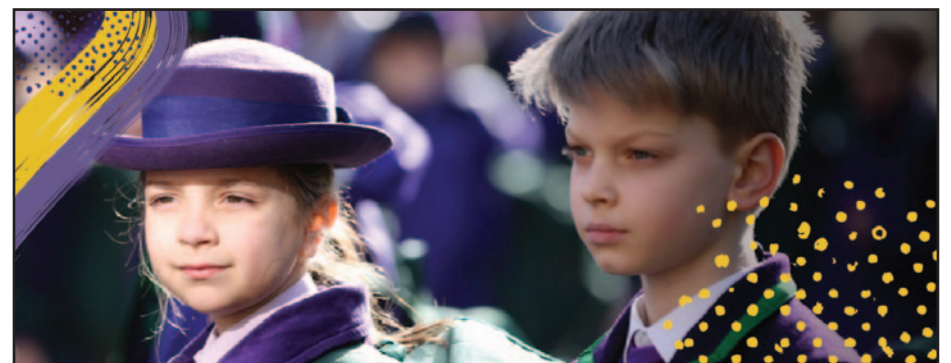

 **The
Pointer
School**

Part of  Dukes
EDUCATION Family

A leading London prep school for girls & boys 3-11
in Blackheath, SE London. Founded in 1950

“...our wonderful teachers and Head Teacher, Mrs Crookes. With patience, good humour, and just a little craziness, they have coaxed and inspired us to achieve things we would not have thought possible!”

Head: Charlotte Crookes

0208 293 1331 pointers.school [@pointerschool](https://www.instagram.com/pointerschool)

FEATURES

London in Bloom 2024



Thursday session volunteers and Jason with the awards

Great news for Head Gardener Jason Sylvan and the Charlton House Garden volunteers – they have achieved a coveted Gold award from London in Bloom (part of RHS Britain in Bloom)! Two categories were entered: the competitive “Our Community” and also the RHS “It’s Your Neighbourhood”. Although these look for gardening excellence, they also cover community involvement. The judges visited on a very hot day in mid-June and had already been to several local gardens including Charlton Station and Orchard when they arrived at the gates of Charlton House. On reflection, it was a great idea to show them around the estate in reverse order – the Meadow and Wilderness, followed by the Glade and Long Garden, then finishing with the jewel that is the Walled Gardens. Following that route they saw the progression of work and Jason was able to explain his ideas for each different area. The best words in the final report were reserved for the beautiful Old Pond Garden – the judges report says, “Jason, working with the volunteers, has restored the walled garden quite possibly to something that is better than the original walled garden.” They go on to say, “We see the harmony of working with volunteers, who have been able to put many of Jason’s thoughts, with his expert guidance, into reality.” What an accolade! All this has been achieved since the Volunteer scheme started just before Covid lockdown in 2020. The judges particularly loved the Glade, with its mounds made of green clippings and excess soil, demonstrating how nothing goes to waste and the creativity of making a flat area more interesting. Of the three sections in

the marking schedule, the judges gave an amazing 97% for Gardening Achievement (plant selection, maintenance, creativity, overcoming site difficulties and enhancing green spaces with planting). Then 90% for Community Participation (actions making a difference to local people, involving local people with planning, communication and implementation). So all these plant sales and garden trails are clearly appreciated! And 83% for Environmental Responsibility (conservation, composting, recycling, improving green spaces, sharing skills, litter, graffiti etc). The gardens also gained a Level 5: Outstanding, for RHS ‘It’s Your Neighbourhood’. Thanks must go to the RBG Greenwich Neighbourhood Growth Fund, who gave the original funding to Charlton & Blackheath Amateur Horticultural Society (CABAHS) and prompted the confidence to start this project. Also to the Royal Greenwich Heritage Trust for their support and to Provender Nurseries Swanley, who give a great trade discount on many of the core plants used. As the ceremony was drawing to a close, the 2024 Judges Award for Best in Category was announced. The volunteers nearly fell off their chairs when it was announced that they had won. But they proudly collected this special prize on behalf of “Jason and the Gardenaughts”! The gardens are a lovely local, free, amenity – this is an excellent step to get visitor numbers up. More volunteers always welcome! Charlton House Walled Gardens open Mon-Sat 10-4 Volunteer sessions Tuesdays 2-4 and Thursdays 10-12. Visit <https://cabahs.com/old-pond-garden/> Kathy Aitken
Treasurer, Charlton & Blackheath Amateur Horticultural Society

Coade Stone

Coade Stone, called by the Greek name, Lithodipyre, meaning fired twice, is an artificial stone named after Mrs Eleanor Coade (1733 -1821) who was a very enterprising woman. In 1770 she purchased an artificial stone manufacturing business at Lambeth, on the site of what is now the Festival Hall, from Daniel Pincots.



Coade Stone looks and feels like worked stone but is actually a ceramic, similar to stoneware. Mrs Coade did not invent the recipe but perfected it by experimenting with the ingredients. The manufacturing process, that required very skilled labour, was time-consuming and expensive. It was fired for up to four days in incredibly hot wood-fired kilns which needed to be monitored day and night to maintain the necessary high temperature. It involved the production of plaster moulds which were retained for many years for future repeated use. The sculpture was made 8 to 10% larger than the originals to allow for shrinkage which occurs during the firing process. Following the firing the final process required rubbing down the edges and filling joints where necessary as larger pieces were made like a jigsaw in separate sections that needed expert assembly.

It was widely used in the late 18th and early 19th century by the great Georgian architects working for George III and the Prince Regent. Her clients included Robert Adam, John Nash, Sir John Soane, James and Samuel Wyatt, and Sir William Chambers, who specified it for architectural details on their buildings, including column capitals, friezes and classical-style door and window surrounds. So many examples of Coade stone

still exist in the UK and around the world due to its very high resistance to weathering. It is considered virtually weatherproof and because it was so durable Coade stone was ideal for creating complicated classical statues and garden ornaments. It can be found on many famous buildings including St George’s Chapel, Buckingham Palace, the Royal Pavilion Brighton and Apsley House, Hyde Park. The County Hall lion on Westminster Bridge which was made in 1837 is an outstanding example. It was originally commissioned by the Red Lion Brewery and placed at the entrance to the Festival of Britain exhibition before eventually being moved to the County Hall site in 1966.



In King William Court at the Old Royal Naval College, we have the Nelson Memorial which the Coade Artificial Stone Manufactory Company, as it was called, considered their finest work. The large sculpture was constructed using the complex jigsaw method involving many individually fired sections. The memorial was placed there in 1813 after Nelson’s death in 1805. It is a sculpture by Joseph Panzetta with British/American artist Benjamin West. A similar memorial in Coade stone to General Wolfe based on West’s painting The Death of Wolfe was planned for the still-empty pediment in the Queen Mary Court. Coade stone was still produced for several decades after Mrs Coade’s death at 88 years in 1821 but it was eventually replaced by the new invention of Portland cement.

David Fletcher FCSD
Fellow of the Chartered Society of Designers

SPARKLYSMILE
CREATING SMILES SINCE 1948

Can whitening expertise successfully performed over 20 years, employs the latest bonding edge treatments to achieve a smile that's worthy of the silver screen.

Call 020 8852 0442

Need enlightening on whitening?

sparklysmile.co.uk • @sparklysmile
19 MONTPELIER VALLÉ • BLACKHEATH VILLAGE • LONDON SE1 7TA • INFO@SPARKLYSMILE.CO.UK • 020 8852 0442

St
St Olave's Prep School

Contact us for further information or to arrange a tour

“ The quality of the pupils’ academic and other achievements is excellent ”
ISI Inspection Report

www.stolaves.org.uk. Call 020 8294 8930

ENVIRONMENT

Save our Swifts



Photo: Robert Booth

These wonderfully aerobic summer visitors are easy to spot, resembling flying arrows! They spend most of their lives on the wing, only ever landing to nest, and arrive here in April and May after spending the winter in Africa.

A Crisis

It is estimated that there was a 60% reduction in the UK swift population between 1995 and 2020.

Causes

The BTO (British Trust for Ornithology) considers that the ultimate drivers of the decline are likely to include:

1. Changes in modern building techniques and the demolition/removal of older buildings have drastically reduced the availability of essential nesting sites for swifts. Unlike swallows and house martins, swifts use existing holes, cracks and crevices for their nest sites.
2. The decline in their diet of insects due to habitat loss, climate change, pesticides and pollutants.

How can we help?

The swift is one of the few endangered species that individuals/communities can help,

- by:
1. Protecting/preserving existing nest sites.
 2. Making (or reopening) new openings to retain access to existing sites.
 3. Lobbying your local MP, council and government to pressure developers into installing Integral Swift Bricks* in all new developments and enshrining this in law.
 4. Fitting an external swift nest box - they are cheap to buy/easy to make.
 5. Increasing the number of flying insects in your garden by growing nectar/pollen-rich plants; going chemical free; constructing a garden pond.
- * Integral Swift Bricks are designed so that the visible part of the box takes the space of a single brick and is designed to blend into surrounding brickwork. They are therefore cheap and easy for contractors to install.

Shirley Broughton
<https://hannahbournetaylor.com/the-feather-speech-campaign-for-swifts/>

Letter

Do we really need leaf blowers in Westcombe Park?

Many will say yes, they are a useful tool for tidying outside spaces. But what about the consequences? The leaves and hedge trimmings may be cleared up but how do they affect the environment, neighbours and wildlife? All leaf blowers are noisy and often disturb neighbours over significant distances, especially those that are petrol powered. Perhaps more importantly, leaf blowers damage the environment. Those that are petrol powered pump out noxious pollutants, a study in the US says that you'd have to drive a Ford Raptor 235 miles, stopping every 505 seconds and doing a cold restart, to emit the same level of hydrocarbons as simply idling a two-stroke leaf blower for less than 10 minutes. Leaf blowers also emit particulates and disturb dust and soil leaving particles hanging in the air that can damage the lungs of

everyone who passes by, as well as those who operate them or use the area in which they are used. Leaf blowers also blow away all kinds of organic matter needed for healthy soil which exposes plants to pathogens and disturb and displace wildlife, much of which is beneficial to the environment. We therefore ask again, do we really need leaf blowers in Westcombe Park? In the suburban gardens of Westcombe Park wouldn't it be as quick, or almost as quick, to use a broom or rake or simply leave the leaves around trees and shrubs as mulch? Next time you or your gardener are about to get out the leaf blower please think twice and reach for the rake or broom instead and, if your gardener insists on a leaf blower, please ask them to use an electric one which will hopefully be less noisy and will certainly be less polluting.

Name and address supplied

WRISTWORTH HEATING & PLUMBING

Installation - Servicing - Repair

Tel: 07725 008280
 Email: wristworth@hotmail.co.uk

GAS safe REGISTER

Check Out Our NEW Website: wristworthheating.weebly.com

Greenwich Park

The Greenwich Park Revealed project is nearing completion. It has involved the replacement of a number of trees, particularly around the parterre. Many of the older trees were diseased and have been replaced by more resilient species.

PLANNING APPLICATIONS*

www.westcombesociety.org

56 HARDY ROAD ref 24/3096/HD
 To construct single storey rear extension and raise roof of the utility out-rigger, and install new sliding doors and roof lights.

144 HUMBER ROAD ref 24/2905/HD
 To replace roof tiles (retrospective).
TREE WORKS
 FERNDALE COURT,
 WESTCOMBE PARK ROAD ref 24/3232/TP
 To crown lift, prune, and/or remove deadwood for 11 trees, pollard London plane, and fell cherry.

* Please be advised that the planning applications noted here are based on information available at the time of print. For the latest updates, please visit our website www.westcombesociety.org

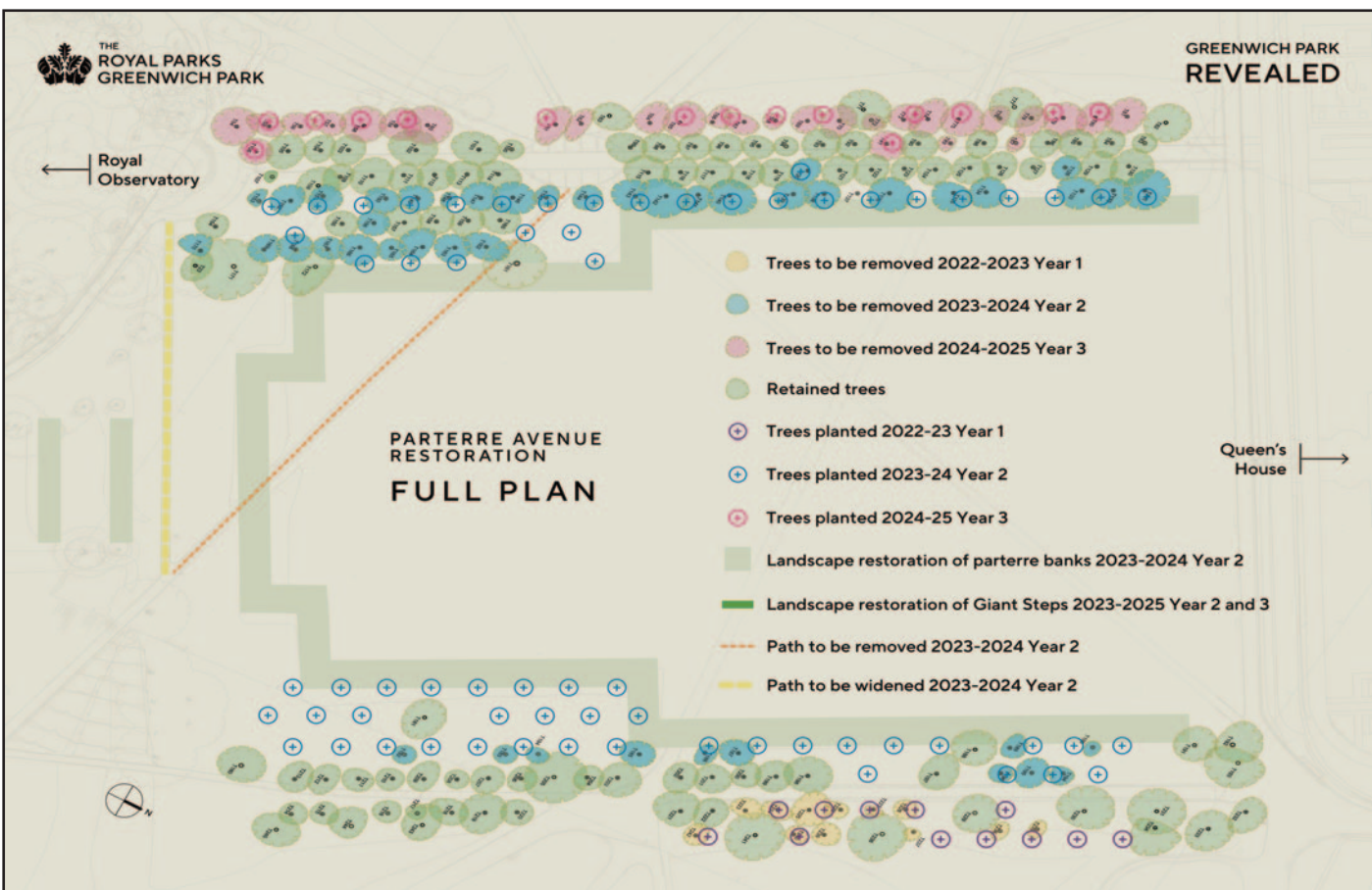

A & A LANDSCAPES
 Landscape Specialists

Free advice & Qualified estimates horticulturalist

All aspects of soft & hard landscaping work carried out including

- * Maintenance * Site clearance
- * Turfing * Tree surgery
- * Fencing * Patios
- * Brickwork

Tel. 020 8318 2530

PSYCHOTHERAPY

For all your emotional and cognitive needs.

Psychotherapist with over 30 years experience in trauma, neurodiversity, depression, anxiety, nightmares, abuse.

I work with adults, teenagers, couples and families.
 Based in SE4

email: secchitherapy@gmail.com
 07957563320

WHAT'S ON

National Maritime Museum & Queen's House, Greenwich

Astronomy Photographer of the Year 16
Date: Daily from 13 September 2024
Time: 10.00 – 17.00

Age: Suitable for all ages
Location: National Maritime Museum Photography Gallery
Admission: Free
www.rmg.co.uk/astrophoto

EVENTS

Remembrance Day: A Call to Mind

Date: 17 November 2024
Time: 12.30 – 16.00
Age: Suitable for all ages
Location: Queen's House, Greenwich
Admission: Free

Family Trails and Backpacks at the National Maritime Museum

Pick up a family trail or borrow a backpack of activities from the 'Play and Explore' trolley at the National Maritime Museum to discover exciting objects in the galleries
Date: Daily 10.00 – 17.00
Age: Suitable for all ages
Location: National Maritime Museum
Admission: Free

Family Trails and Backpacks at the Queen's House

Discover art, conservation, and the stories of the Queen's House with the Create trail and the Creative Conservator's kit.
Date: Daily
Time: 10.00 – 17.00
Age: Recommended for ages 6+
Location: Queen's House, Greenwich
Admission: Free
www.rmg.co.uk/queens-house/queens-house-family-trail

Royal Observatory

Morning Stars

Date: 2 November 2024 10.15 – 11.00
Suitability: Recommended for older children or anyone who would benefit from a more in-depth look into the subject of astronomy
Admission: Adult £10 | Child £5 | Free companion tickets are available
www.rmg.co.uk/whats-on/royal-observatory/morning-stars

South Asian Astronomy: Diwali

Dates: 1 November 2024 10.30 – 11.15
Age: Suitable for ages 7 and over
Admission: Adult £10 | Child £5
<https://www.rmg.co.uk/royal-observatory>

Charlton House & Gardens

Macbeth performed by Shakespeare and The Squares- 15th of November, 7.30pm – 9pm

<https://shakespeareinthesquares.co.uk/venue/charlton-house-se7/>

Sparkle In The Park- 28th, 29th, 30th of Nov and the 1st of Dec, 4.30pm – 9pm

Each evening will be a spectacle of stunning light installations, a Christmas Market, fun fair and performances from local schools and community choirs. As with previous years, there will be a quiet hour on the Sunday 1st from 4.30pm – 5.30pm for children and adults with special educational needs and disabilities (SEND).

Westcombe News November 2024

Cutty Sark



Cutty Sark Sea Shanty Festival

Enjoy a day of sea shanties onboard the world-famous Cutty Sark, during the fourth annual Sea Shanty Festival.

Dates: 23 November 2024

Time: 10.00 – 16.30

Age: Suitable for all ages

Location: Cutty Sark

Admission: Free with entry to the ship

www.rmg.co.uk/whats-on/cutty-sark/sea-shanty-festival-2024

Charlie Connelly: Attention All Shipping

To mark Cutty Sark's 155th birthday, Charlie Connelly will be performing a one-man show based on his bestselling book Attention All Shipping: A Journey Round The Shipping Forecast.

Dates: 22 November 2024

Time: 18.30 – 21.00

Age: Suitable for ages 18 and over

Location: Cutty Sark

Admission: Adult £20

www.rmg.co.uk/whats-on/cutty-sark/charlie-connelly-attention-all-shipping

Cutty Sark Comedy

Comedy at Cutty Sark returns this November.

Date: 24 November 2024

Time: 18.30 – 20.30

Location: Cutty Sark, Michael Edwards Studio Theatre

Admission: £18

www.rmg.co.uk/whats-on/cutty-sark/cutty-sark-comedy

Sea Shanty Singers

Cutty Sark's resident sea shanty groups Swinging the Lead and The HogEye Men.

Dates: 2, 3 November 2024

Time: 11.45 | 12.45 | 13.30

Age: Suitable for all ages

Location: Cutty Sark

Admission: Free with entry to the ship

www.rmg.co.uk/whats-on/cutty-sark/sea-shanty-singers

Half-Term on Cutty Sark

There will be daily activities on Cutty Sark during the half-term break, including creative workshops on science and innovation.

Dates: 26 October – 3 November

Time: 11.00 – 13.00 | 14.00 – 16.00

Age: Suitable for all ages

Location: Cutty Sark

Admission: Free with entry to the ship

Blackheath Christmas Fair

Sunday 17 Nov 10.30am - 4.45pm

This popular Fair returns for its 11th year to Blackheath Halls with over 40 local artisans selling handmade and bespoke gifts. The event is organised by Friends of Age Exchange raising money to help people live well with dementia. £3 entry (Free to Friends & under 16s). All sales support Age Exchange and their dementia services.
www.age-exchange.org.uk/christmasfair

The Arts Society Greenwich

www.theartsocietygreenwich.org.uk



The Men who made Menswear

Monday 11 November at 7.30 pm

Lecturer: Russell Nash

Venue: James Wolfe Primary School, Royal Hill, Greenwich

Guests very welcome: £10

This lecture tells the story of men's tailoring over the past 200 years, told through the lives of the men who commissioned and created and wore it. Tailors, shirtmaker, hatters and other craftspeople in London's west end, especially around Savile Row & Jermyn Street have shaped the way men dress since the Regency. How did men such as Beau Brummell, The Duke of Windsor, Alexander McQueen and John Stephen create their signature looks which influenced the mens fashion? This lecture also looks at the wider cultural shifts since the early 19th century to the present day and how they affected the way that men present themselves.

Greenwich Society

Coffee and Chat

The Greenwich Society hold monthly free sessions in the upstairs area of the Parkside Cafe at the National Maritime Museum with its lovely view of the Park. They are held on the first Wednesday of the month from 11am, and include a ten-minute talk of local interest. See below to see upcoming talks.

Wednesday 6th November

Topic: Plans for the community activities at St Alfege Church.

With Wendy Foreman, communications lead at St Alfege Church.

Wednesday 4th December

Topic: A Festive Theme: Christmas in Greenwich - some history.

With Jacky Robinson

Mycenae House

Fri 1st Nov 7.30pm - Mexican Day of the Dead. GFMA present a fantastic night of live music from The Mexican Way Mariachi band and delicious Mexican food. £26.

Sat 9th Nov 10.30am - Dementia Music Session. For care givers & those living with dementia, with award winning singer and pianist Eleanor Meynell. Free.

Fri 15th Nov 8pm - Dave Sutherland. Dave brings his award winning one man Americana/Country with special guests Siobhan Parr & Damien Renouf. £12.50.

Fri 22nd Nov 8pm - Adrian Legg. An amazing English guitar player who has been called "impossible to categorize". £16/14.

Sun 24th Nov 10am-4pm - Christmas Craft Fair. The Corner @ 96 present local artists and makers over two floors, stock up on all those Christmas gifts. Free entry.

Thurs 28th Nov 4pm - Bach to Baby concert. Classical Concert for families. £15.

For more information, please visit:

<https://mycenaehouse.co.uk/whats-on/>

Blackheath Halls

Sat 2 Nov 11am & 3pm - Jack and the Beans Talk

Mon 4 Nov 1.10pm - Lunchtime Recital Ana Julija Mlejnik Železnik
Sat 9 1pm/4pm & Sun 10 Nov 10am/1pm - Peppa Pig's Fun Day Out

Sun 10 Nov 8pm - Rich Hall | Shot from Cannons

Wed 13 - Sat 16 Nov - London International Festival of Early Music

Mon 18 Nov 1.10pm - Lunchtime Recital Ophelia Gordon

Sat 23 Nov 7.30 - Taiko Meantime
Sat 23 Nov 8pm - Daliso Chaponda | Feed This Black Man Again

Sun 24 Nov 4pm - Holst: The Planets Family Concert

Sun 24 Nov 7pm - Holst: The Planets Full Concert

Thu 28 Nov 7.30pm - Alice Hunt: Republic

Fri 29 Nov 6pm - Trinity Laban Side by Side

<https://www.blackheathhalls.com/whats-on/>

BLACKHEATH PREP

Where every child shines

Join our outstanding school at 7+

Excellent 11+ and senior school results

Year 3 places available
September 2025 entry

Apply online
blackheathprep.co.uk

Apply by
5 December
2024

MARKET PLACE

TUITION

SPANISH TUITION, on line, latinoamerican Spanish teacher. All levels and ages, GCSE, A levels. Please contact: Miguel at 07910318513 or migansiergut52@gmail.com

ART TUITION

I am a practicing artist looking to tutor all ages and abilities including GCSE and A-Level. Please write to ac@allan-collinsartist.com

MATHS & ENGLISH TUITION TO GCSE AND PREPARATION FOR 11+ AND INDEPENDENT SCHOOL SELECTION TESTS by qualified and experienced teacher.

marystuition.com

Mary Bauckham 07709 089 838

marybauckham@gmail.com

HOME SUPPORT AND

TRAINING FOR YOUR

DIGITAL DEVICES

Need some help with computers, phones and tablets? I'm a DBS checked IT trainer with 21 years experience, friendly and patient. £45/hour (£20 call out), discounted for block bookings.

To discuss options, call Paul on

07958 251 448 or email

paul.clayton@soulchip.co.uk

MATHS TUITION

Qualified and experienced secondary teacher offers tuition to GCSE level.

Call Miv Whitaker: 07745 816338;

or email miv.whitaker@gmail.com

SERVICES & TRADE

VANBRUGH DOG WALKING.

Insured, DBS checked, business references. £15 per hour for one dog; other prices on request. Please email:

vanbrughdogwalking@hotmail.com

ACCOUNTANCY,

BOOKKEEPING & PAYROLL

SERVICES including VAT

Returns. 07946 530053

hello@companyfinances.co.uk

UPHOLSTERER

Specialising in traditional upholstery.

www.suemayesupholstery.net

or phone 07932 040 298

TRAINED CHIMNEY SWEEP

& STOVE INSTALLER

Fast, friendly Happy to work!

Call Anthony

on 07772 649577 or email:

chimneymaintenance@gmail.com

INTERIOR DECORATOR with

over 30 years experience. Free

quotations and friendly advice on

all your decorating requirements.

Telephone Ashley Greaves

07880984508.

PEST CONTROL SERVICES

Mice, Rats, Squirrels, Wasps,

Foxes etc. Local Service 07850

839 655

T.TA ELECTRICS. NICEIC

Approved Contractor, Quality

Tradesman. All electrical work

undertaken, Fully Insured & Guaranteed.

24HR EMERGENCY ELECTRICAL.

Please call Tony on 07961 509

403 OR 020 8488 7425 OR

info@ttaelectrics.co.uk

HOMEWORKS All-round

handyman for those DIY's you

have no time for! General repairs.

Painting & Decorating. General

Carpentry and flooring. Flat-pack

assembly. Patio and deck clean-

ing. No job too small.

Contact Matthew Barron

07903 388658

ELECTRICIAN / ALARM

ENGINEER

No job too small TMIET

registered.

Call 07879 011792

WESTCOMBE CLEANERS

I'm a friendly, hard-working &

organised domestic cleaner.

Regular or single services.

Competitive rates. Additional

tasks. I love my clients to be

happy. Phone 07746 291617

TOM ELLIS

BESPOKE CARPENTRY

Alcove bookcases, cabinets,

wardrobes and window seats.

M. 07510 869 947

MARK CHEESEMAN, LOCAL

CARPENTER AND JOINER

WITH OVER 30 YEARS

EXPERIENCE.

All Aspects Of Carpentry and

Construction Executed

Considerately and to a High

Standard. Both Traditional and

Contemporary Design Joinery -

Cupboards, Window seats,

Floating Shelves, Engineered

Flooring Fitted Etc. Also Locks

Changed. Sash Window Overhaul.

If you have Rotten Window Sills,

Door Frames Etc. rather than

replace them with the associated

upheaval and expense, why not

have a Timber/Resin Repair?

Please Call Mark on 07767

456131 or H: 020 8854 4028.

ANGELO, ELECTRICIAN

No Job Too Small

T - 020 87616012/

M - 07850 767 283

Email - angelo@glennies.net

Part P Certificated

18th Edition & JIB Registered

LOCAL CARPET CLEANER

Specialist in cleaning Carpets,

Upholstery & Rugs.

www.carpetcrew.co.uk

Phone 07828503132

A MAN AND A VAN

Tel: 020 8858 3889

Mobile: 07885 917842

HOLIDAYS

WHITSTABLE

WEEKENDS/WEEKS

Seawall house between Oyster

Warehouse and harbour.

Sleeps 5. Fantastic Views.

Email -

tess.roberts@hotmail.co.uk

Phone - 07958377336



GREENWICH
herbaria
Garden Design and Care



Specialists in Horticultural Happiness!

Garden Advice Xmas Gift Vouchers now Available!

E: greenwichherbaria@gmail.com
T: 07400 587674 / 07903 621499



TROJAN PRESS

NOW TAKING ORDERS
FOR CALENDARS AND
CHRISTMAS CARDS

1a Lizban St

Blackheath, London SE3 8SS

Tel: 020 8853 2268

Email: info@trojanpress.co.uk

www.trojanpress.com

DISCOUNT!

(When you show your Westcombe Society membership card)

ALL CITY LOCKSMITHS LTD

offer upto a 15% discount for local residents

ROYAL NEPALESE

RESTAURANT (Station Crescent) 20%

OFF meals for two or more

Sunday - Thursday.

COTON & HAMBLIN LENS CLUB-

Complimentary standard coated single

vision lenses worth £50 when

purchasing complete spectacles.

T's & C's apply.

BLACKHEATH EYECARE

OPTICIANS

Money-saving Eyeplan

membership offered

TROJAN PRESS 10% OFF all

quotations

WESTCOMBE DRY CLEANERS

10% discount on Dry Cleaning. Cannot be used in conjunction with any other offers.

A * DRIVING SCHOOL

£5 discount on the price of

one x 2 hour lesson

KAREN STOREY OF

HOMESPACE offers members 10%

discount on decluttering &

homestaging: 07951 191086

SHENDA FALVEY PERSONAL

TRAINING, STOTT PILATES & BOOT-

CAMPS

M: 07887727335

E: shenda@shendafalveypersonaltrain-

ing.co.uk

Free Bootcamp worth £12.50

Free PT/ Pilates Consultation with 20%

off first session

PAINTING & DECORATING

Interior/Exterior/
Experienced Reliable Clean
Fully Guaranteed/Insured.
References available.
Free no obligation quote
and advice given

JOHN at JAMES & LAMONT







Office 020 8462 4646

Mobile 07802 535695

jamlam.john@btinternet.com

Bruca Gardens | Local gardeners

We offer regular and one-off garden maintenance services for private and residential gardens.

-  Garden design
-  Landscaping
-  Garden clearance
-  Garden maintenance
-  Planting and soft landscaping
-  Trees and shrubs specialist pruning



Contact us at **07896992548**
brucagardens.co.uk

IBS
BLACKHEATH HIGH
EARLY YEARS
GDST

I'm queen of the jungle!

Where girls boldly go

Book a Nursery and Forest School tour: admissions@bla.gdst.net

FINALIST 2024
INDEPENDENT SCHOOLS OF THE YEAR AWARDS